

region.CoMa

The region.CoMa exhibition at Form/Design Center in Malmö was a multimedia installation consisting of an online computer, a sound image and 4 video projections. The exhibition also included a 26 page web catalogue, a seminar on regional urbanity and a guided bus tour around the Öresund region.

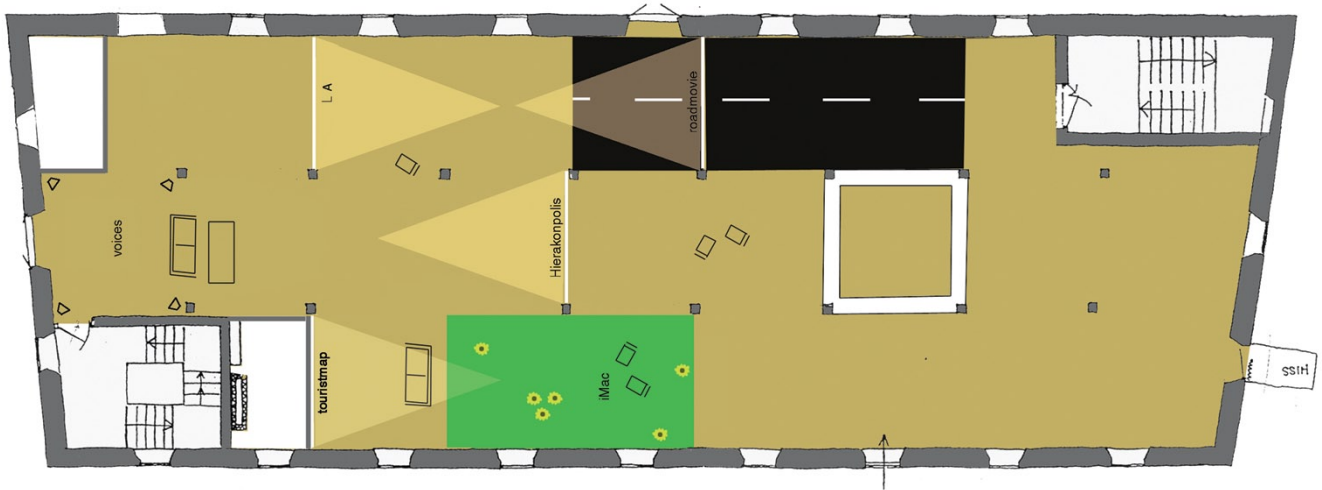

CoMa, short for Copenhagen-Malmö, is an ongoing research project on the development of urban regions. The project includes studies of the urban region of Los Angeles and the new Öresund region in Scandinavia.

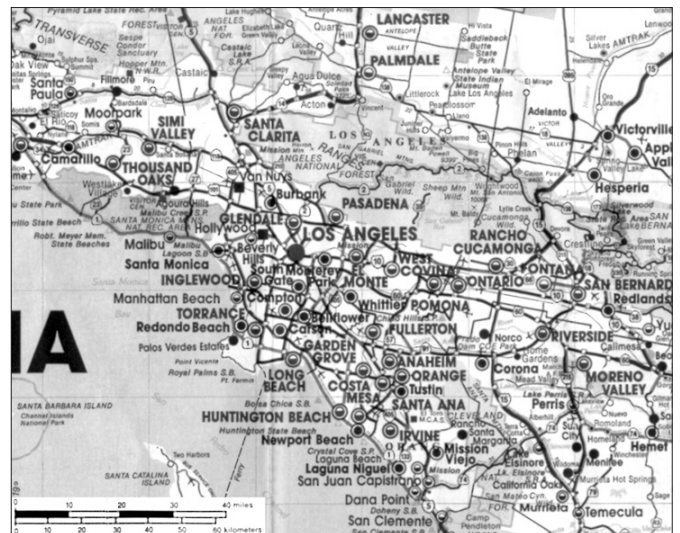

The process of regional urbanization is seen as a response to the emergence of a multicultural network society. Though many of the inhabitants of the Öresund region choose to live in rural settings, nearly all have direct access to most major urban facilities.

The network structures absorb and distribute the global flows of capital and people, but they also enable the formation of more or less autonomous tribes and ghettos. Thus the urban region encompasses many different worlds, co-existing without necessarily interconnecting.



Tourist Map

Tribe and ghetto map of the Öresund region

Running time: 12 min.

It is believed that the first Spanish and Sicilian ghettos were established by Jews themselves. Not until the 14th century were the Jews of some cities specifically forced to live in ghettos segregated from the rest of the city. Contemporary urban populations are increasingly seeking like-minded people. The new ghettos therefore do not merely accommodate outcasts, but rather people from all levels of society who feel they share a common social or cultural identity differentiating them from others. Thus it is no longer the ghetto that is segregated from the city, but the city that is being segregated into ghettos.

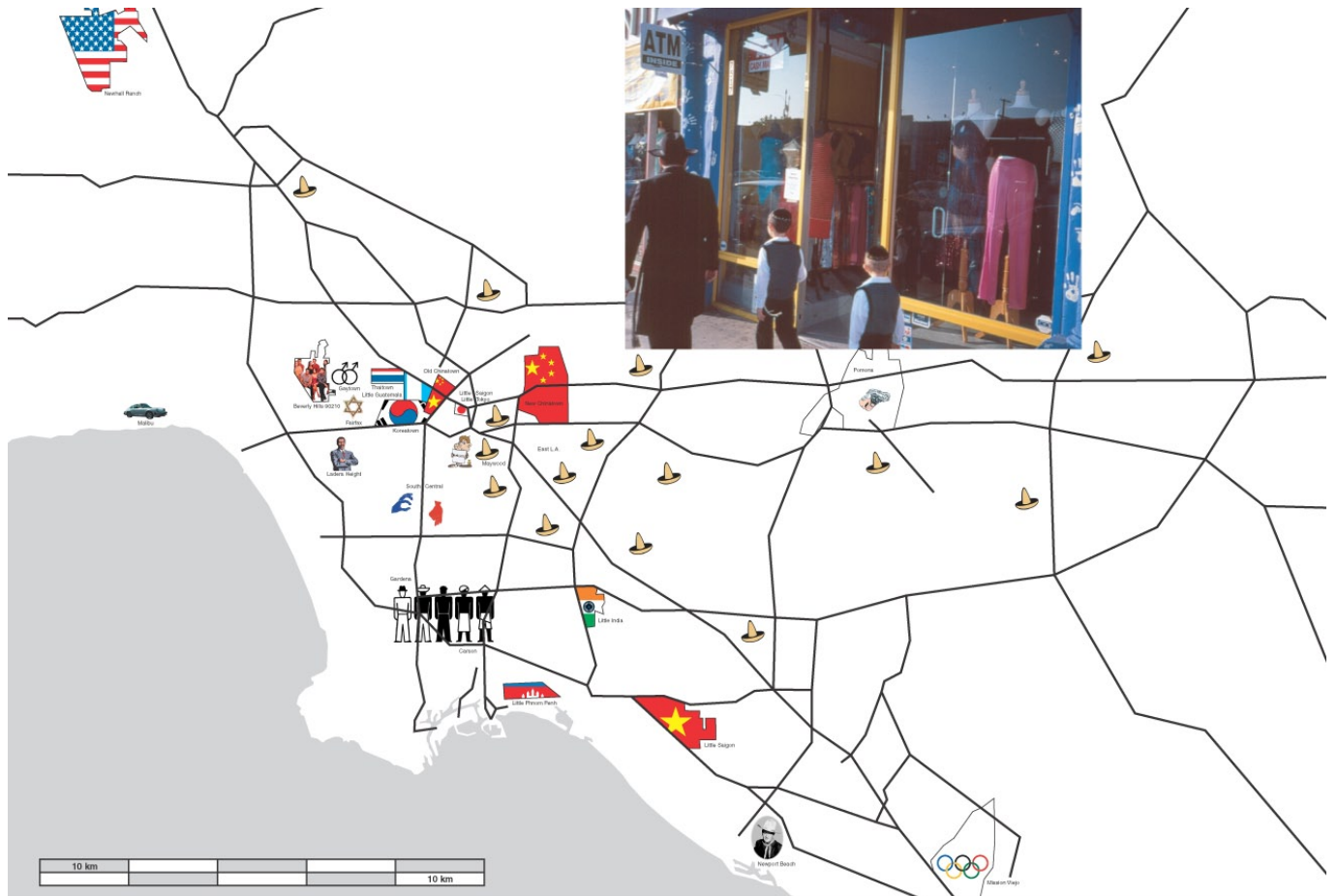

LA lyx, med judiska affärsdistrikt och muslims

LA

Mixed media map of the Los Angeles region

Running time: 30 min.

In LA hundreds of homeless people live in cardboard homes on the pavements of Skid Row, while others pay hundreds of dollars for a new shirt from one of the exclusive fashion shops along Rodeo Drive. With its composition of 3rd world slum areas and the most extravagant luxury of the western world, Jewish business districts and Muslim mosques, black ghettos and Hispanic barrios, hippie cultures and fanatical sects, LA is not only one of the world's most heterogeneous urban regions, it is as such one of the most radical democratic experiments yet to be seen, and thus also an authentic expression of the global situation.



Hierakonpolis

Animated section of Egyptian wall painting from 3200 BC

Running time: 3 min.

The New Carlsberg Glyptoteket's copy of the Griffith Institute's reproduction of the lost original. Discovered in the prehistoric cemetery of Hierakonpolis. Later destroyed by local villagers.

Dating from a period known as Sequence Date 63, it was painted just before the invention of the hieroglyphs and the establishment of the first Pharaoh Dynasty. The two events mark the transition to historical time.

The picture contains a series of distinct scenes. The conception of reality that this and many other prehistoric pictures express, namely that situations which are disconnected in time can co-exist in space, mirrors modern conception of reality, in which situations that are disconnected in space can co-exist in time.

In prehistoric times events occurred in slow motion, making them incomprehensible to the human memory as part of a historic evolution. With events now unfolding in fast forward motion, it becomes equally difficult to maintain that sense of evolution. Having lost the linear time-space order it can be argued we have entered a post-historic era.

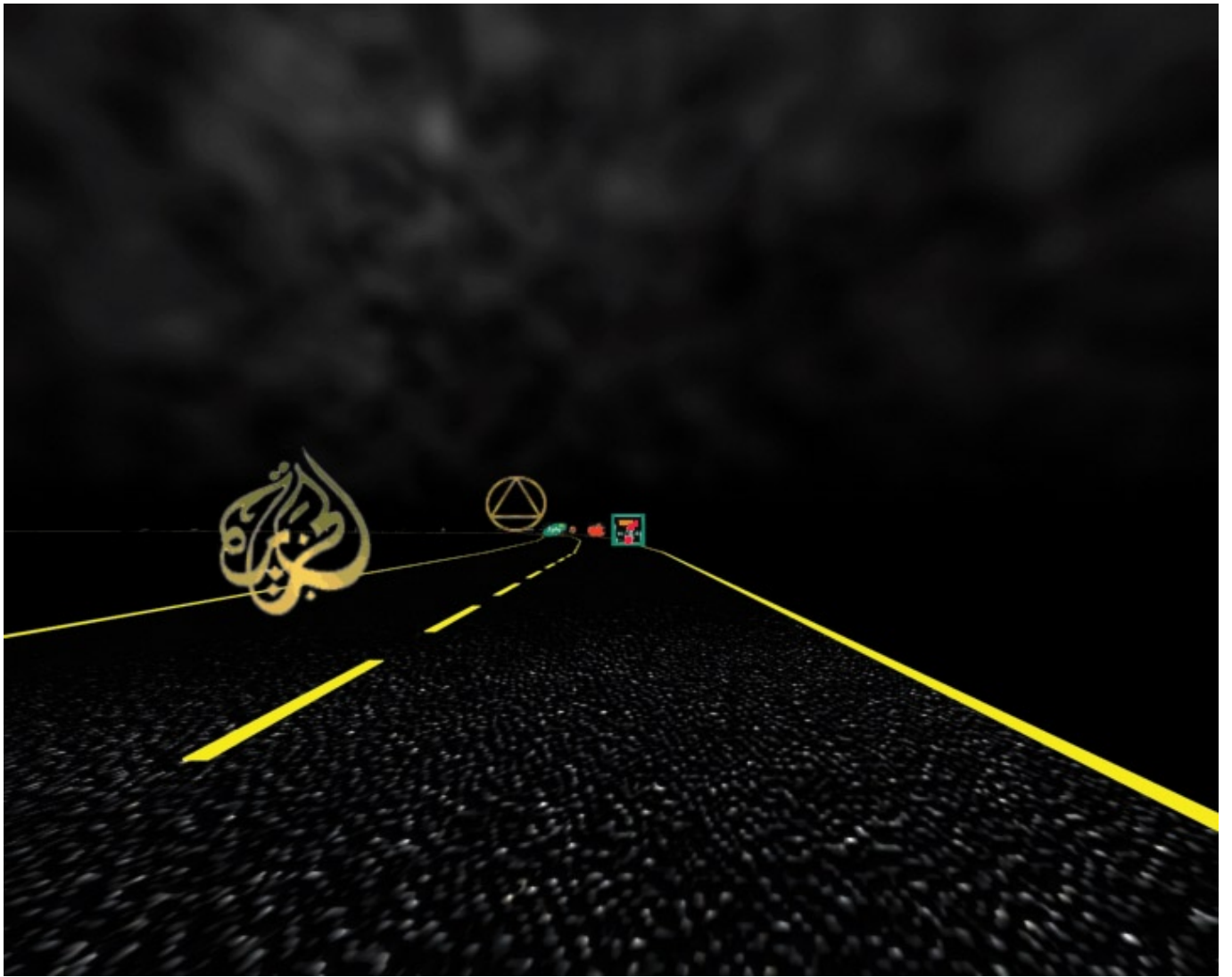

Road Movie

Video game imagery

Running time: 5 min.

Today we move in landscapes of signs, referring to something other than what is actually there.



Voices

Sound image

Running time: 8 min.

In addition to the visual installations the exhibition contained a sound image of a fictitious phone conversations in various languages. Voices being played as a soft background noise.

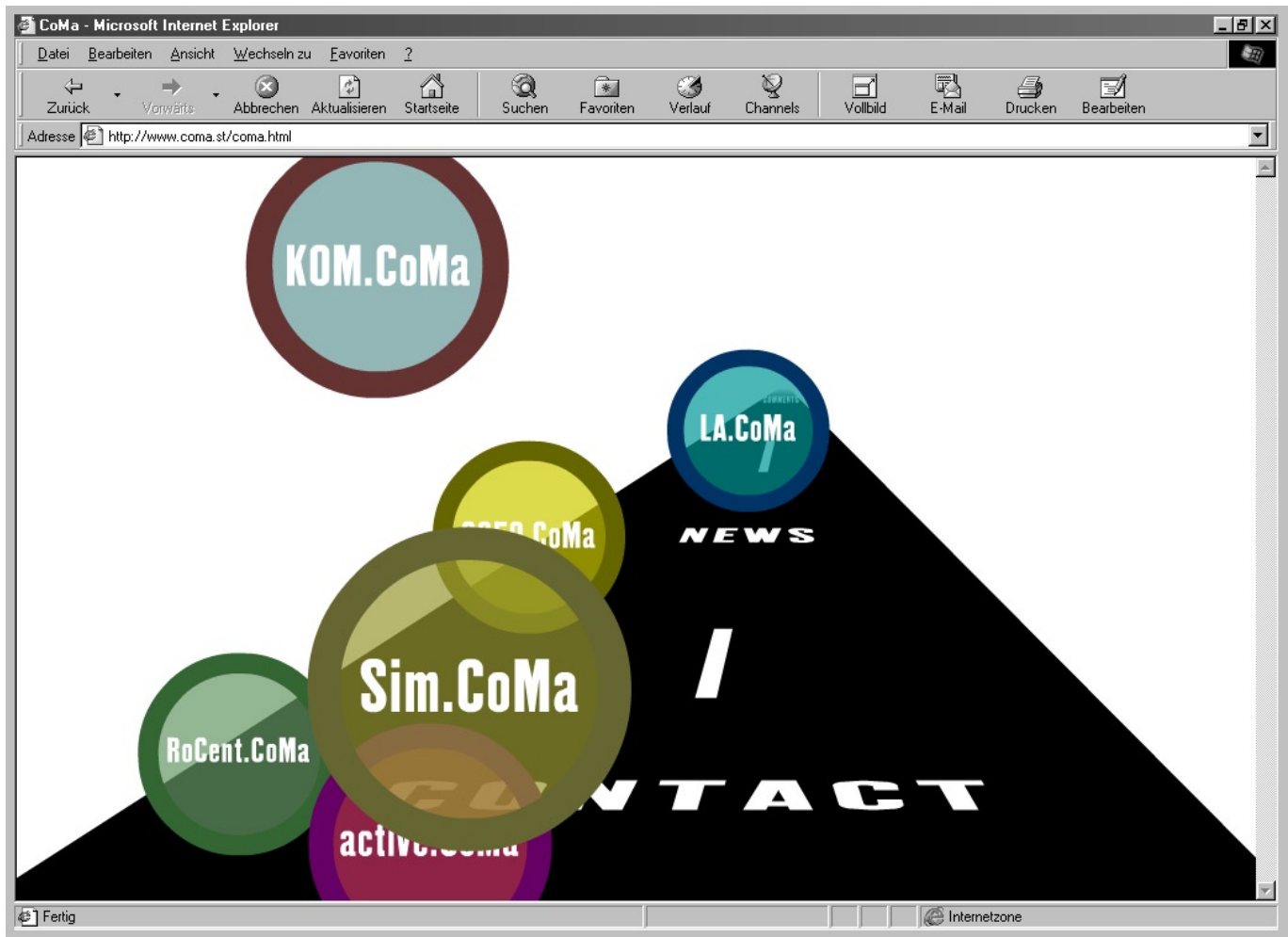

imac

Online computer with a screensaver showing, in real time, the schedule for international flight departures from Copenhagen Airport and with direct access to the CoMa website.

19:25		LH 9959	Berlin/Teg	Closed
19:25		SK 1501	London/He	Closed
19:25	19:30	SK 424	Stockholm	Boarding
19:30		JZ 609	Linkoeping	Closed
19:30	19:45	LH 3131	Cologne	Closed
19:35	20:00	SK 549	Amsterdam	
19:40		DM 119	London/Gat	Boarding
19:40		KF 674	Tampere	Closing
19:40	20:25	SK 1414	Stockholm	
19:40		SK 2541	Dublin	Boarding
19:40	20:30	SK 714	Helsinki	To gate
19:45		BT 140	Riga	Boarding
19:45	20:05	SK 1539	Manchester	
19:45	20:00	SK 2593	Brussels	To gate
19:45		SK 619	Zurich	Boarding
19:45		SK 995	Beijing	Boarding 19:50



about.CoMa

A public debate on regional urbanity.
Introduction by Henrik Valeur and Fredrik Fritzson.



see.CoMa

A guided bus tour to tribe and ghetto formations in the Öresund region.